

Best BH9000 Model – Install Touchless Safeguard Liquid Hand Soap Dispenser

1 of 2

Products Needed



Safeguard®
Liquid Anti-
Bacterial Hand
Soap

Tools Needed

- Drill & Drill Bit (1/4 inch)
- Hammer
- Screwdriver, Phillips Small
- Tape Measure & Level

Frequency

As Needed

Special Directions

(4) new C cell alkaline batteries will be needed.

Link to Training Video



Scan the QR code or click the link to see the training video.

<https://bit.ly/41c86Kt>

Dispenser Installation

1

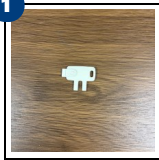

Locate the clear bag that contains various parts and set aside. Remove the white plastic key.

2



Remove the various labels from the parts bag. Apply the appropriate product label by centering it across the width of the dispenser near the bottom of the cover.

3



Open the dispenser cover from the top using the white plastic key by pushing down through the key holes. Avoid damaging the unit by exerting unnecessary pressure.

4



Remove the refillable reservoir cartridge from the dispenser. Remove cap. Position the reservoir over a sink basin to avoid spilling product inside the dispenser. Pour liquid hand soap into the reservoir. Replace cap and set aside.

5



Place the unit on a flat surface. Press down on the **LOCK** button and turn the dial to **position 1** to change the hand care dispensing type. Release **LOCK** button and ensure the dial does not move.

Setting Dial:

- Liquid or Gel = Position 1
- Foam = Position 2
- Atomizer = Position 3

Avoid a Weak Voltage

Issue: Ensure the **LOCK** button is centered. If an adjustment is needed, install the batteries. Close the cover without installing a product bottle. Place your hand under the dispenser to activate the sensor which allows the lock button to center itself underneath. Remove batteries.

6



Locate a clean sturdy wall to install the dispenser. Allow 6 inches for the top of the dispenser to be accessed and 12 inches for the cover to flip open. Ensure the sensor is not obstructed by objects or accidentally triggered by reflective surface.

Best BH9000 Model – Install Touchless Safeguard Liquid Hand Soap Dispenser

2 of 2

American Disabilities Act (ADA)

Requirements: To meet ADA requirements, install all hand soap/sanitizer dispensers so that the top of the push bar is 40–inches from the floor.



Hold the unit and level against the wall and mark (3) holes for mounting. Avoid plumbing or electrical wires.

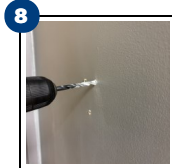

Use a drill and appropriate 1/4 inch drill bit to bore holes through the (3) mounting holes for an exact fit.



Use a hammer to install mounting anchors.



Secure the dispenser to the wall using screws.



Open the lid to the battery box. Install the (4) new C cell alkaline batteries in the correct orientation.

Avoid Battery Damage:

- Do NOT use old and new batteries together.
- Remove batteries if the dispenser will not be used for a long period of time.

Install Drip Tray



Install the drip tray hooks into holes at the bottom of the dispenser. Slide tray back to lock into place.

The Palmer drip tray is another option that can be used with the dispenser. It should be mounted to the wall.

NOTE: Drip tray prevent accidental sensor activation and guide the guest to intuitively place their hand in the correct location for the sensor to accurately dispense.

Select the Dose

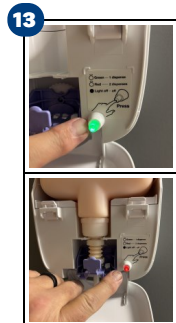

Locate and verify the dispenser **LED GREEN/RED MODE** switch on the battery operating compartment is lit. This button controls the **ON/OFF** function and the number of doses.

Dosing Guidelines:

- **Green LED** Lit Light = **1 dose**
- **Red LED** Lit Light = **2 doses**
- **OFF** = **OFF**



Push this **MODE** switch button to ensure the LED light is **GREEN**.



Install the filled cartridge reservoir into the dispenser. Confirm the pump attachment at the bottom of the cartridge bottle is seated properly.



Close the dispenser cover. After closing the cover, the unit is programmed with 3 second delay before dispensing.



Place your hand under the dispenser to test the automatic pump. Repeat several (20 – 30) times until you see one dose dispensed into your hand.

Dispenser LED Troubleshooting:

- **Green (ON)** The LED flashes when dispensing product.
- **Green (Flashing)** The LED flashes when the battery is low.
- **Red (Flashing)** The batteries are dead and the unit will not operate. Replace the batteries immediately.
- **Green/Red (Flashing Alternately)** The sensor is detecting soil on the lens or reflective light.