

# How to Install A Tytro Pro 2-Button Dilution Center [3-Compartment Sink]

1 of 3

## Frequency

**Special Directions**  
(CCT 006)

### Link to Training



Scan the QR code or tap the link below to view the video.

<https://bit.ly/3T9v9m3>

#### Tools Needed:

- Drill Bits 5/16 inch [Masonry or Standard]
- Drill, Charger & Battery
- Hammer
- Level, Bullet or Torpedo
- Marker & Tape Measure
- Phillips Bit w/ Extension
- Plastic Tubing Cutter
- Screw Drivers [Flathead & Phillips]

#### The Standard Kit Includes:

- (1) Tytro Pro 2-Button Dilution Center
- (2) 1-Gallon Product Racks
- (1) Generic Wall Chart
- (1) Water Supply Hose & Hose Filter Washer 30-Mesh
- (2) Discharge Hoses
- (1) Roll of Product Supply Tubing
- Bags of Stickers, Metering Tips, Mating Caps
- Bag of Accessories (Zip Ties, Faucet Adapter Items, Screws & Anchors)

### Prior to Starting Install

- 1 Confirm at the 3-compartment sink:
  - Other items that effect the placement of the dispenser. (i.e. shelves, racks, etc.)
  - Which sink will be the wash basin.

### Secure the Dilution Center to the Wall

- 2 Ensure potential water source is within 6 feet of the dilution center:

#### Most Common Water Sources:

- Dedicated faucet
- Overhead sprayer

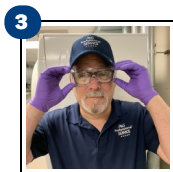

**Recommendation:**  
Put on safety glasses.

- 4 Unpack the dilution center.

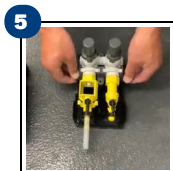

Disassemble the Tytro Pro dilution center cabinet cover and water valve bracket/educator assembly. Set items aside.

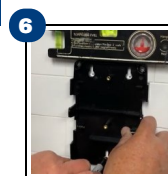

6 Install above the wash sink basin. Hold the cabinet back plate and level against the wall and mark (3) holes for mounting.

### Dilution Center Install Requirements:

- When the 1-gallon wall racks are installed above the 3-comp sink, the dilution center must be installed 11 inches above the bottom of the wall racks. Incorrect install will result in a siphoning issue.
- When the 1-gallon wall racks are installed below the 3-comp sink, the dilution center can be installed 4 inches above the backsplash of the sink.

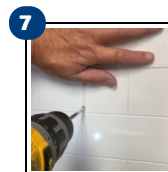

7 Use a drill and appropriate 5/16 inch drill bit to bore holes for (3) wall anchors.

- 8 Use a hammer to install mounting anchors.

# How to Install A Tytro Pro 2-Button Dilution Center [3-Compartment Sink]



Use a drill and Phillips bit or screwdriver to install the cabinet back plate. Secure with 3 screws.

If needed, be sure to clean sink basins.

## Installing Discharge Tubes & Hoses



Attach the out discharge hose to the air-gap eductor. Move the hose (worm gear) clamp into place.

11 For quaternary sanitizer, attach the outer discharge tube to the eductor. E-gap eductor does not have an inner discharge tube.

12 Reassemble the water valve bracket/eductor assembly to the backplate. Ensure it is secured.

13 Route the sanitizer hose to the sanitizer sink basin. Ensure there are NO low dips in the hose. Use zip ties to secure the hose and ensure proper drainage into the sanitizer sink.



Use tube cutters to trim length of the detergent and sanitizer hoses. The hoses should not extend more than 3" - 4" into the sink basin and should be above water fill line.

15 Rotate the hose until straightened. Tighten the hose (worm gear) clamp on the sanitizer solution discharge hose.

## Wall Racks



Install the 1-gallon product wall racks. Follow the **Slim Rack System** procedure or training video. Scan the QR code or click the link below to see the video.

<https://bit.ly/3JxFsY6>

### Install Wall Racks Above the 3-Compartment Sink Backsplash:

- Ensure the bottoms of the wall racks are installed on the wash side drainboard.

### Install Wall Racks Under the 3-Compartment Sink:

- Ensure the bottoms of the wall racks are at least 6 inches above the floor. (This option requires drilling holes in the stainless steel sink basin.)

## Route and Secure the Product Supply Tubing



Insert the correct metering tip into the eductor hose barb. Make sure tip is fully inserted.



Install the supply tubing onto the mating cap barb. Attach the product label flag to the tubing. Place product bottle in the wall rack and twist the mating cap onto the bottle.

19 Route the supply tubing from the mating cap to the hose barb.

20 Cut the supply tubing with some slack near the hose barb. Allow for some movement of the product bottles for replacement.

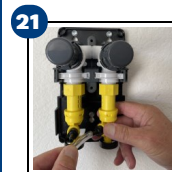

Attach appropriate supply tubing to each hose barb and metering tip.

**NOTE:** Secure the supply tubing. Use zip ties where applicable.

## Install Water Supply Hose

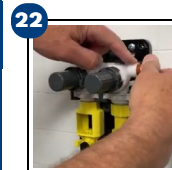

Install the 3/8 by 3/4 inch brass threaded fitting on the water manifold that is closest to the water source.

23 Install the 3/8 inch plastic water plug.

**NOTE:** Follow local plumbing regulatory requirements for installing dilution equipment. If regulatory requirements are strict, follow these.



# How to Install A Tytro Pro 2-Button Dilution Center [3-Compartment Sink]

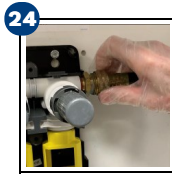

24 Install the water supply hose and open the water valve(s).

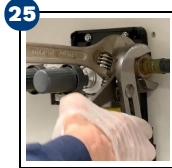

25 Ensure the dilution center is correctly installed. If water drips are present, tighten the connections.

## Prime Product Supply Tubing

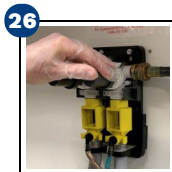

26 Push the buttons on the dilution center until product is pulled through the supply line into the dilution center and dispensed into the sink basin.

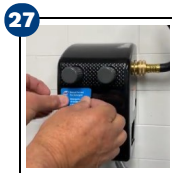

27 Re install the cover onto the dilution center. Apply product labels onto the cover.

28 Put up the wall chart, wash/rinse/ sanitizer sink basin labels and 800# sticker.

## Prepare Solutions for Use



29 Fill a sink basin approximately to the half full mark.

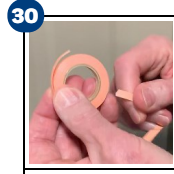

30 Test the sanitizer solution. Follow the **Test Quaternary Sanitizer Solution** procedure or training video. Scan the QR code or click the link below to see the video.



<https://bit.ly/3aOMMkz>

