

# Wall Pump Installation at the 3-Compartment Sink

1 of 3

## Tools Needed

- Anchors & Screws
- Drill & Hammer
- Drill Bit [3/16 inch]
- Drill Bit [Phillips]
- Marker & Wall Zip Ties
- Phillips Screw Driver

## Frequency

### Special Directions

This is a wall installation procedure. The pump kit can be installed on a wall, sink back splash. Do NOT install on a sink counter top. If wall space is limited, use the hand pump system at the 3-compartment sink.

## Link to Training Video



Scan QR code for click the link below to see the training video. (CCT 103)

<https://bit.ly/45duqnn>

## Wall Pump Kits

Each pump kit contains:

- (1) Wall Pump
- (1) Directional Spout
- (1) OSHA Spout Limiter Plate [required]
- (1) Supply Tubing [6 inches, 3/8 inch diameter]
- (1) Standard Supply Tubing [14 feet, 1/4 inch diameter]
- (1) Reducer Connector [1/4 inch x 3/8 inch]
- (2) Plastic Flow Restrictors
- (4) Threaded Screws (2 long & 2 medium)

## Prepare the Limiter Plate for Install



1 Unpack the wall pump kit. Wall racks are purchased separately.



2 Use Phillips head screwdriver to remove the 2 small screws on the front of the "limiter plate." pry the pump from the limiter plate.

## Assess the Install Location

- 3 Assess the surrounding wall area to ensure that electrical outlets or sink water supply lines are not directly below or above the area to be drilled.

**NOTE:** Ensure there is adequate space for the "limiter plate" to be installed close to the sink basin. The limiter plate directs the spout downward into the sink basin. This prevents splashes to the face when the solution is dispensed.

- 4 To prevent damage to the wall pump, allow for space between the bottom of the wall pump and the top of any large ware sitting in the sink basin.

## Install the Limiter Plate and Pump

**NOTE:** Walls made with the following materials need anchors installed to secure the dispenser.

- Brick, Concrete, Masonry
  - Dry Wall
  - Fiberglass Panels
  - Stainless Steel Sheets
- NO anchor is needed if installing to a wood wall stud.

- 5 Place and level limiter plate on the wall. Mark holes to be drilled.
- 6 Drill the (4) marked holes with a drill and drill bit. Drill slowly, if resistance is encountered, stop drilling. This is an indication that water/drain pipes are in the wall. Find a new hole, repeat steps.
- 7 Use a hammer to tap the wall anchor into the hole(s). Ensure the anchor is flush to the wall.

# Wall Pump Installation at the 3-Compartment Sink



8 Remove the button plunger nut from the pump assembly. Use caution as the plunger is spring loaded.

**IMPORTANT:** Do NOT touch the lubricated parts of the internal plunger. Touching lubricated areas may result in leaks and/or improper seal of the plunger.



9 Remove the pump cover from the pump assembly.



10 Without the cover and button plunger, re-install the pump body to the "limiter plate". Use 2 small screws to secure "limiter plate" to the pump body.

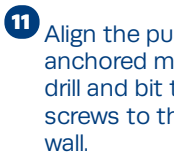

11 Align the pump against the anchored mounting holes. Use drill and bit to secure 2 (long) screws to the "limiter plate" and wall.



13 Gently twist the discharge spout onto the wall pump outlet port. A flow restrictor is at the end of the spout.

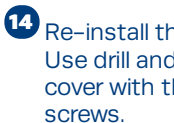

14 Re-install the wall pump cover. Use drill and bit to secure the cover with the 2 (medium) screws.

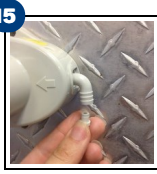

15 Install the plastic flow restrictor to the input port on the wall pump. The flow restrictor helps eliminate drips that can occur at the spout.

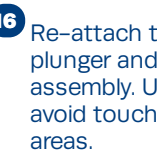

16 Re-attach the spring, button plunger and nut to the pump assembly. Use caution and avoid touching the lubricated areas.

## Install Product Bottle Parts



17 Use drill, anchors and screws to install 1-gallon wall racks under the wash sink. This prevents siphoning of product.

**NOTE:** Ensure the bottoms of the racks are at least 6 inches above the floor.



18 Install the supply tubing to the the mating cap barb. Attach the product label flag to the tubing. Place product bottle in the rack and twist the mating cap onto the bottle.

## Route the Supply Tubing

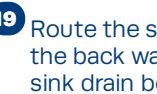

19 Route the supply tubing from the back wall over the wash sink drain board or basin.



20 Cut the supply tubing. Allow for slack near the wall pump input port. Also allow for movement of the product bottles for replacing bottles.



21 Cut a 2 inch piece of the larger (3/8 inch diameter) supply tubing.

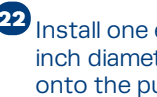

22 Install one end of the larger (3/8 inch diameter) supply tubing onto the pump inlet port.

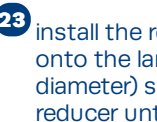

23 install the reducer connection onto the larger (3/8 inch diameter) supply tubing. Push reducer until it is firmly in place.



24 Connect the smaller (1/4 inch diameter) standard supply tubing onto the reducer.

**NOTE:** Use drill, bit, anchors, screws and zip ties to secure the supply tubing to the wall.

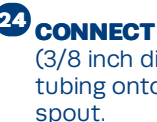

24 **CONNECT** the left over larger (3/8 inch diameter) supply tubing onto the end of the spout.

## Prime the Pump

**CAUTION:** Before pumping quaternary sanitizer concentrate, always point the spout in a direction that prevents an eye, face or skin splash.

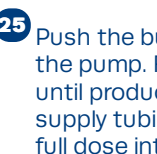

25 Push the button a full stroke of the pump. Repeat this action until product pulls through the supply tubing and dispenses a full dose into the sink basin.



# Wall Pump Installation at the 3-Compartment Sink

**Installer Tip:** Dawn detergent is thick. It takes longer for the pump to recover between strokes. Prime the supply tubing line with clean water for a smooth draw. Place the Dawn mating cap into a container of clean water and pump it through the system. Re install the mating cap to the detergent product bottle. Prime the detergent through the system.

- 26 Ensure the pump is correctly working without leaks or drips at the pump button. If drips are present, tighten the button nut.

## Sink Basin Set Up

- 27 Determine the "Gallon Capacity" of the sink basin.

### Product Dosing Guidelines Based on Sink Size:

- **5 Gallon Sink = 1 Pump** (or 1 ounce)
- **10 Gallon Sink = 2 Pumps** (or 2 ounces)
- **15 Gallon Sink = 3 Pumps** (or 3 ounces)
- **etc.**

- 28 To mark the sink fill level use cleaner and paper towel to clean interior of sink basin. Apply the "Fill-Line" sticker above the 3/4 full mark.

## Prepare Solution for Use

- 29 Apply the 1 pump for 5 gallons of water sticker, 800# and product labels near the pump.
- 30 Pump the amount of product into the sinks based on the "gallon capacity."
- 31 Fill the sink basin with fresh water to "Fill-Line" level.
- 32 Mix the solution in each basin with a mixing tool. Ensure the tool is rinsed with water before mixing the quaternary sanitizer solution.

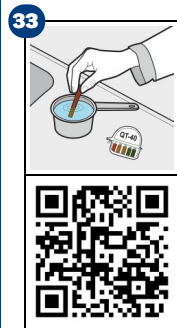

33 Test the sanitizer solution by following the **Test Quaternary Sanitizer Solution** procedure. Scan the QR code or press the link to see the training video.

<https://bit.ly/3aOMMkz>