

Operating 3-Lever Hose System

Products Needed



Spic and Span® Floor and Multi-Surface Cleaner



Clean Quick® Broad Range Quaternary Sanitizer

Tools Needed

- Utility Bucket [For Testing Sanitizer Solution]

Frequency

As Needed

Special Directions

Wear appropriate gloves, if sensitive to cleaning solutions.

NOTE: Refer to **Cleaning Process – 3-Lever Hose System** procedure.

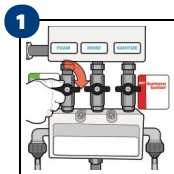

Turn all three valves in the **OFF** or horizontal position. Turn **ON** the water supply valve.

NOTE: Perform **step 2 ONLY** for Lafferty 3-Lever Mobile Hose Cart, it is not applicable for the wall mount.

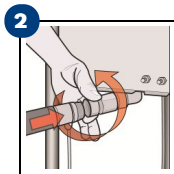

Connect supply hose to water inlet coupling and turn **ON** warm water.

Foam

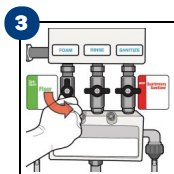

Turn the "FOAM" valve to the **ON** position.

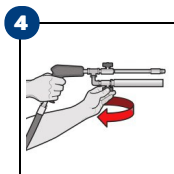

Turn **ON** the valve on the combo gun foam wand and apply foam to cover surfaces.

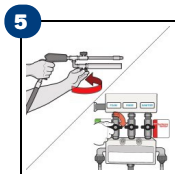

Turn **OFF** the wand valve, and the "FOAM" valve when finished foaming.

Rinse

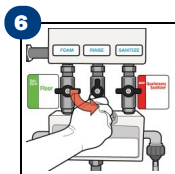

Turn the "RINSE" valve to the **ON** position.

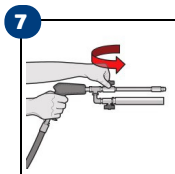

Turn **ON** the valve on the combo gun sprayer wand and apply water to remove chemical residue and soils.

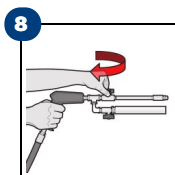

Turn **OFF** the combo gun sprayer valve and the "RINSE" valve when finished rinsing.

Sanitize

NOTE: Once per day check the sanitizer, follow the **Test Quaternary Sanitizer Solution** procedure.

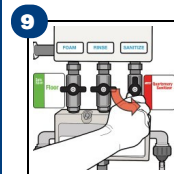

Turn the "SANITIZE" valve to the **ON** position.

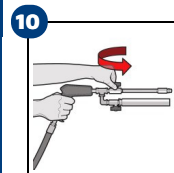

Turn **ON** the valve on the combo gun sprayer wand and apply sanitizer solution to the surfaces.



Allow at least a 1 minute contact time, and adequately air-dry.

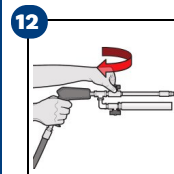

Turn **OFF** the valve on the combo gun sprayer valve and the "SANITIZE" valve when finished sanitizing.

NOTE: Relieve the pressure in the hose by reopening the combo gun sprayer valve. Always close ALL valves after use.

