

# HOTEL GUEST BATHROOM CLEANING

Tools Needed		Products Needed
<ul style="list-style-type: none"> <li>• Sponges or Cleaning Towels</li> <li>• Toilet Brush</li> </ul>		<p>Spic and Span® Disinfecting All-Purpose Spray and Glass Cleaner (3-in-1)      Comet® Disinfecting Bathroom Cleaner      Swiffer® Sweeper &amp; Dusting Cloths</p> 

**FREQUENCY OF CLEANING:** After every occupancy.

**SPECIAL DIRECTIONS FOR THIS TASK:** If sensitivity to cleaning solutions is a concern, wear disposable gloves.



## TUB, SHOWER, SHOWER WALLS, AND SHOWER ENCLOSURE

### STEP 1

- Spray bathroom cleaner directly onto surfaces to be cleaned.
- Spread product across entire surface. For tough soils, allow cleaner to soak for 10 minutes.

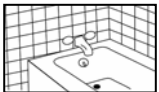

- Scrub all surfaces with sponge or cleaning towel.
- Rinse all surfaces with water. Begin rinsing at the top of shower wall and/or enclosure. Continue rinsing from top to bottom.
- Buff surface with a dry towel.

**NOTE:** Do not use bathroom cleaner on natural marble.

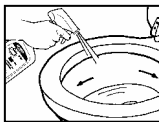

## TOILET BOWL (INTERIOR SURFACES)

### STEP 2

- Spray bathroom cleaner into bowl and under rim of bowl.
- Brush or wipe all interior surfaces thoroughly.

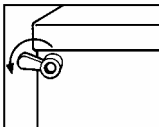
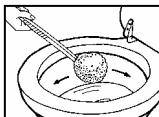

- Flush toilet.



## TOILET BOWL (EXTERIOR SURFACES)

### STEP 3

- Spray 3-in-1 all purpose spray and glass cleaner onto exterior surfaces of toilet.
- Wipe with clean towel.

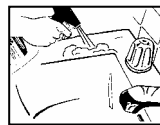
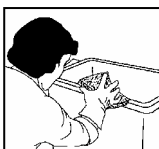

## SINKS AND COUNTERTOPS

### STEP 4

- Spray 3-in-1 all purpose spray and glass cleaner onto countertop and sink surfaces.
- Wipe with clean towel.

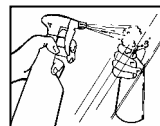

## MIRRORS

### STEP 5

- Spray 3-in-1 all purpose spray and glass cleaner onto mirrors.
- Wipe with clean towel.



**NOTE:** If streaking occurs, use less product and/or do not buff completely dry. Use a separate towel when cleaning glass and mirrors.



## FLOOR

### STEP 6

- Spray 3-in-1 all purpose spray and glass cleaner on floor.
- Wipe with clean towel.



**NOTE:** Allow floor to dry completely before using Swiffer. Swiffer dusting cloths must be used on dry surfaces. Do not spray anything on Swiffer dusting cloth.

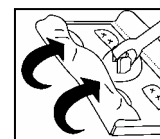

- Attach Swiffer dusting cloth to sweeper.

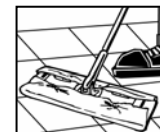

- Sweep floor with Swiffer sweeper to pick-up hair and dirt.

**NOTE:** Be sure to use both sides of dusting cloth. Use one dusting cloth to clean 16 rooms, 8 rooms per side.